

SOUTH NIAGARA SITE LANDSCAPE DESIGN

The future South Niagara Site will provide a safe, accessible and pleasant experience for patients, family, caregivers, staff and physicians. The outdoor landscape will encourage relaxation and social interaction for all users and re-energize staff and physicians. Our landscape will celebrate the historical, geographical and cultural aspects of South Niagara while focusing on environmental sustainability and innovation. A large focus of the landscape design includes outdoor healing environments that respond to the special needs and conditions of patients in specific clinical programs. Providing care through a variety of outdoor spaces will encourage exposure and connections to nature.

Overall Design Elements and Goals

Key features of all landscapes throughout the campus will include:

- Seniors focused design.
- Walkways will be an important part of the landscape to encourage physical and physiological movement throughout the areas.
- Promote a safe environment.
- Bright and well lit.
- Provide ample seating and respite areas.

WELL® Certification

Focused on the health and well-being of our staff, physicians, volunteers, patients, families, caregivers and the Niagara community.

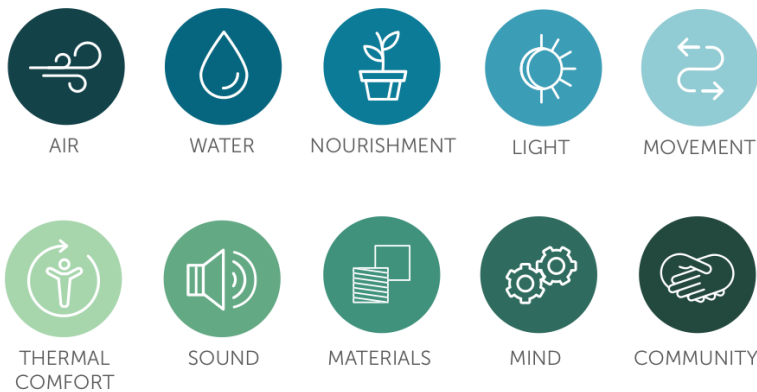

LEGEND

- | | |
|---------------------------------------|--------------------------------|
| ① MAIN ENTRANCE | ⑭ MENTAL HEALTH TERRACE |
| ② COMMUNITY PLAZA | ⑮ AUDITORIUM TERRACE |
| ③ AMBULATORY CARE ENTRANCE | ⑯ SPIRITUAL CARE COURTYARD |
| ④ DIALYSIS ENTRANCE | ⑰ TRANSIT STOP |
| ⑤ STAFF ENTRANCE | ⑱ PEDESTRIAN / CYCLIST NETWORK |
| ⑥ CAFETERIA COURTYARD | ⑲ VEGETATED BUFFER |
| ⑦ LOADING DOCKS | ⑳ STORM WATER MANAGEMENT POND |
| ⑧ HELIPAD | ㉑ NATURAL AREA |
| ⑨ PATIENT TRANSFER ENTRANCE COURTYARD | ㉒ CORNER GATEWAY PLAZA |
| ⑩ AMBULANCE GARAGE | ㉓ STAFF TERRACE |
| ⑪ EMERGENCY WALK-IN ENTRANCE | |
| ⑫ INDIGENOUS HEALING GARDEN | |
| ⑬ SENIOR WELLNESS GARDEN | |

*This site plan is conceptual and for illustrative purposes only.
It is subject to change.*

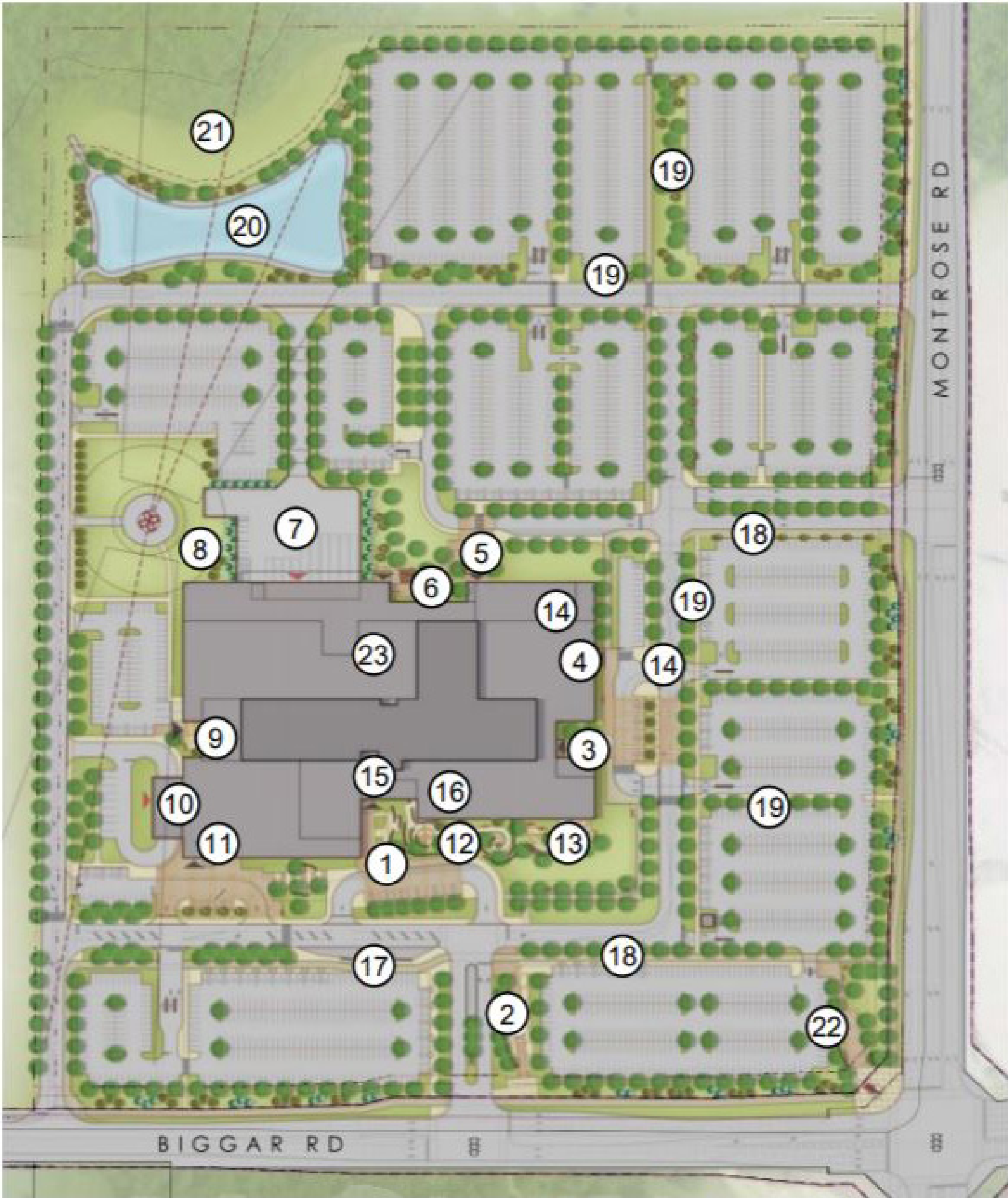

SOUTH NIAGARA SITE LANDSCAPE DESIGN

MAIN ENTRANCE/COMMUNITY PLAZA



Key Users:

Patients, Staff and Physicians, Family and Caregivers, Visitors

Summary:

With landscapes to encourage an informal and naturalistic style, this community space will include greenery, plenty of open space, seating areas and walkways. The main entrance will include a designated drop off area for patients, while encouraging safety and usability for pedestrians. The Community Plaza will be a multi-use space that will include opportunities for community engagement and act as a courtyard to the Main Entrance.

Space Uses:

Walking, sitting, community events, hospital functions

MENTAL HEALTH TERRACE



Key Users:

Mental Health Patients and their respective Family/Caregiver

Summary:

As an environment promoting physical and mental well-being for users, this terrace will encourage nature viewing through plant material, an opportunity for social interaction and a calming atmosphere for relaxation.

These outdoor spaces will be designed to maximize greenery, promote social interaction and tranquility and stimulate the senses. The space will have seating areas, walkways, and provide a safe and secure environment.

Space Uses:

Therapy, reflection, conversation, walking

CAFETERIA DINING COURTYARD



Key Users:

Patients, Staff and Physicians, Family and Caregivers, Visitors

Summary:

A landscape with a social environment to encourage group interaction and conversation, located adjacent to the food services program. With plenty of tables and chairs, shading and greenery, this outdoor oasis will be a welcoming and pleasant area for all. Option for water and or other features will be discussed throughout the planning process.

Space Uses:

Meals/eating, social gatherings, event space

SENIORS WELLNESS GARDEN



Key Users:

Patients, Family and Caregiver

Summary:

A multi-use setting located adjacent to the senior's program and public space. The terrace will provide outdoor seating with views of nature. The space will be designed to accompany mobility devices.

Space Uses:

Therapy, walking, reflection, conversation, reading, nature viewing

INDIGENOUS HEALING GARDEN



Key Users:

Patients, Staff and Physicians, Family and Caregivers, Visitors

Summary:

An environment that provides a feeling of grounding and connection to Mother Earth. A landscape that includes tobacco, sage, cedar and sweet-grass. Plenty of seating with a comforting feel to increase connection to nature and it's healing properties.

Space Uses:

Reflection, conversation, reading, general walkway, Indigenous ceremonies

AUDITORIUM TERRACE

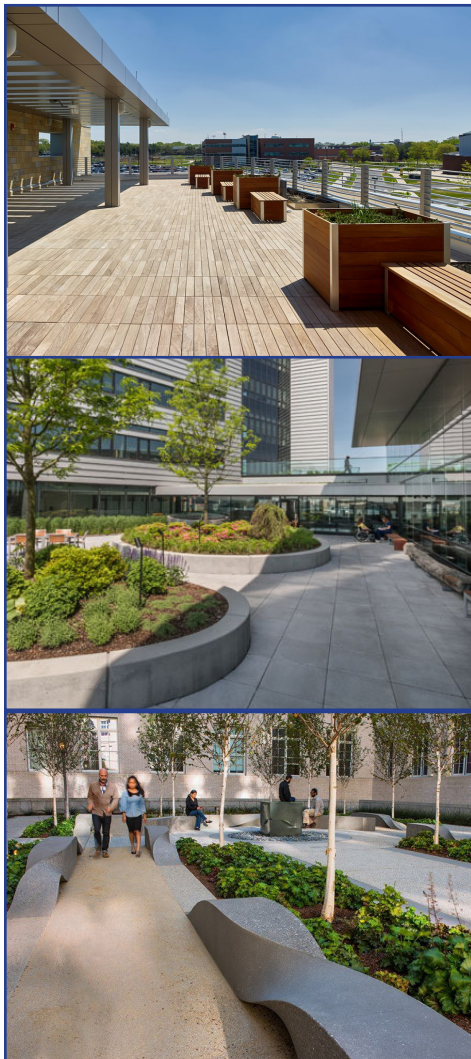

Key Users:

Patients, Staff and Physicians, Family and Caregivers, Visitors, Community

Summary:

An outdoor landscape feature that promotes a connected community and naturalistic style. This space will include greenery, plenty of open space and seating areas. This community space will assist with wayfinding when existing the auditorium space and be a comforting space for reflection with a direct connection to nature.

Space Uses:

Reflection, sitting, community events, hospital functions

SOUTH NIAGARA SITE LANDSCAPE DESIGN

COMPLEX CARE TERRACES (3)



Key Users:
Patients, Family and Caregivers

Summary:
With natural elements designed throughout this space, it will encourage healing, reduce stress and allow users to connect with nature. This area of the landscape will have a mix of walkways, seating areas and greenery which will encourage natural habitats for local wildlife and provide a safe and secure environment.

Space Uses:
Reflection, relaxation, conversation, walking, nature viewing

STAFF GARDEN



Key Users:
Staff, Physicians & Learners

Summary:
A space to encourage relaxation and respite in a secluded garden area, with an abundance of plant material, shade structures and seating areas.

Space Uses:
Relaxation, conversation, walking

ENTRANCE COURTYARDS (3)



Key Users:
1.) Ambulatory Entrance Garden - Patients, Staff and Physicians, Visitors, Patient Transfer
2.) Emergency Entrance Garden - Patients, Staff and Physicians, Visitors
3.) Dialysis Garden - Patients, Staff and Physicians, Visitors

Summary:
A landscape that promotes physical and mental well-being with seating areas in a garden-like setting with screening from adjacent roadways and walkways. Walkway connections will be separate from patient drop off areas and interaction of vehicular movements. Extra care will be taken to ensure the safety and functionality for users.

Space Uses:
Transportation, general walkway, patient drop-off, deliveries

SPIRITUAL CARE COURTYARD



Key Users:
Patients, Staff and Physicians, Family and Caregivers, Visitors

Summary:
A spacious garden area with walkways, seating and arrays of plant material to promote well-being. Options to include water features and sculptures will be discussed throughout the planning process.

Space Uses:
Reflection, conversation, reading, general walkway

GATEWAY PLAZA



Key Users:
Patients, Staff and Physicians, Family and Caregivers, Visitors

Summary:
A landscape that pays tribute and celebrates the site of the hospital and acknowledges the entrance into the Grand Niagara Secondary Plan.

Space Uses:
Walking, landmark

BICYCLES, TRAILS & WALKWAYS

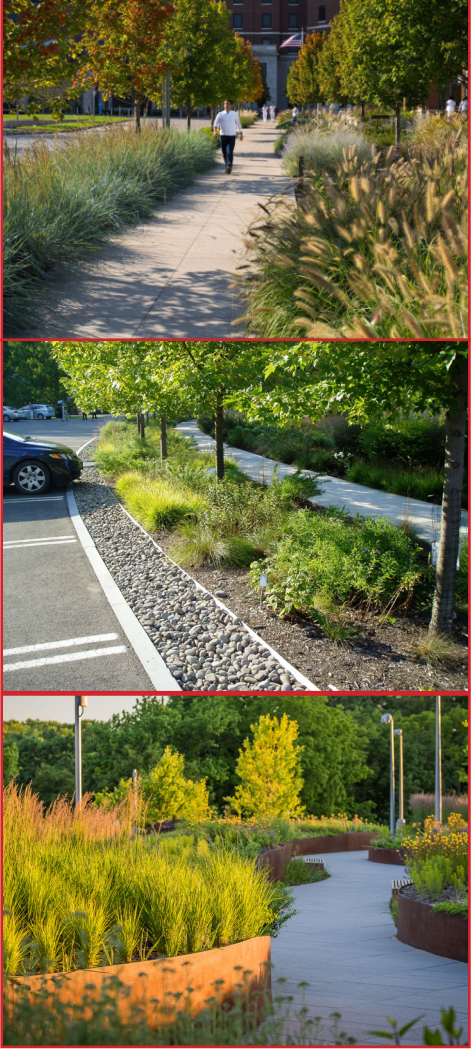

Key Users:
Patients, Family and Caregiver, Staff and Physicians, Visitors, Adjacent Neighbours

Summary:
Surrounding the campus, bicycle routes will be indicated on all roads, with routes to bicycle parking areas in front of designated entrances of the facility. Bicycle parking will be secured and located next to main walkways for convenience. Trails will connect to each other and promote walkability. Walkways throughout the campus will connect to all entrances of the building while doubling as outpatient rehabilitation routes.

Space Uses:
Walking, cycling, general travel throughout campus space